

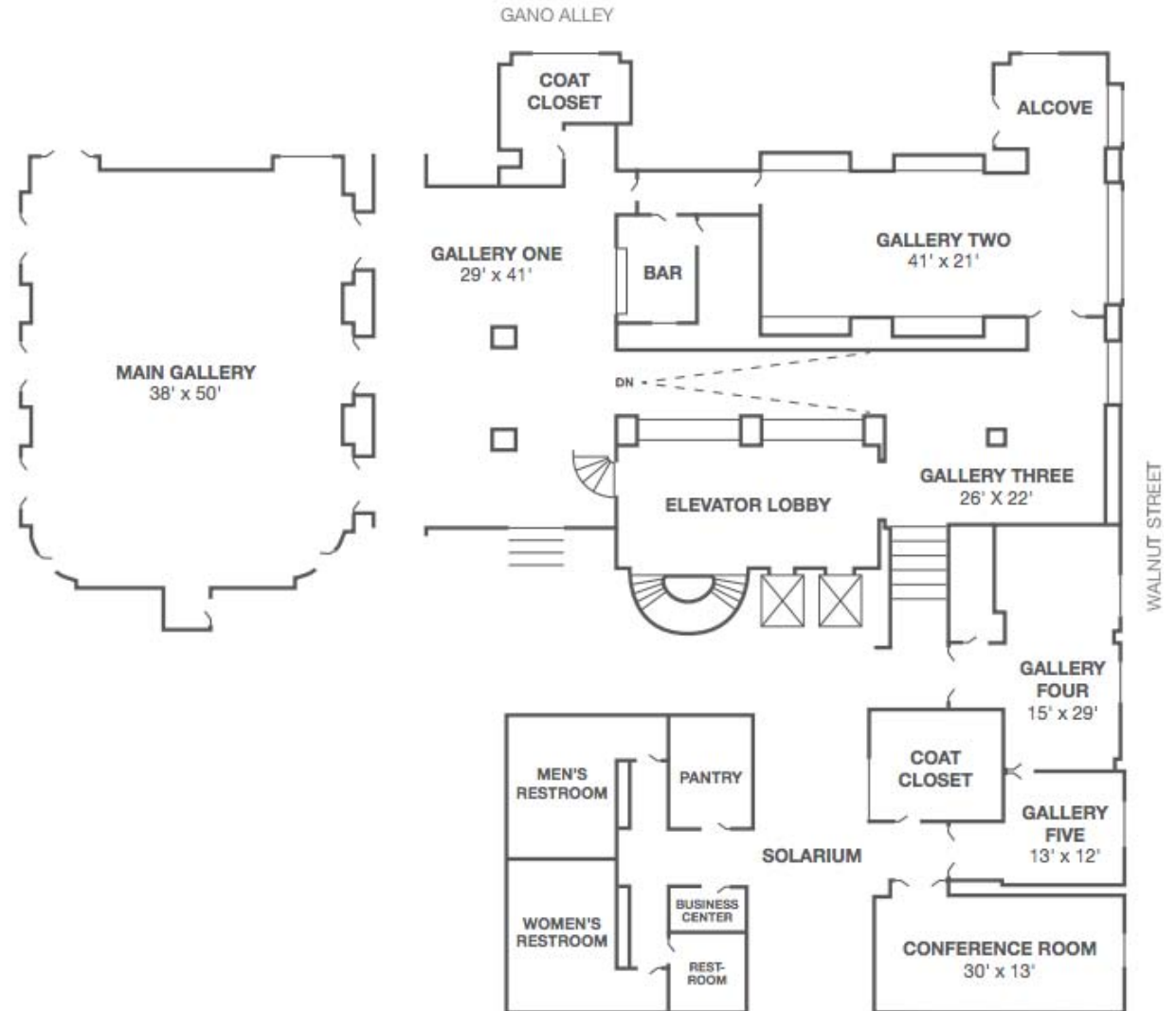

## MEETING + EVENT SPACE FLOORPLAN





## METROPOLE FLOORPLAN

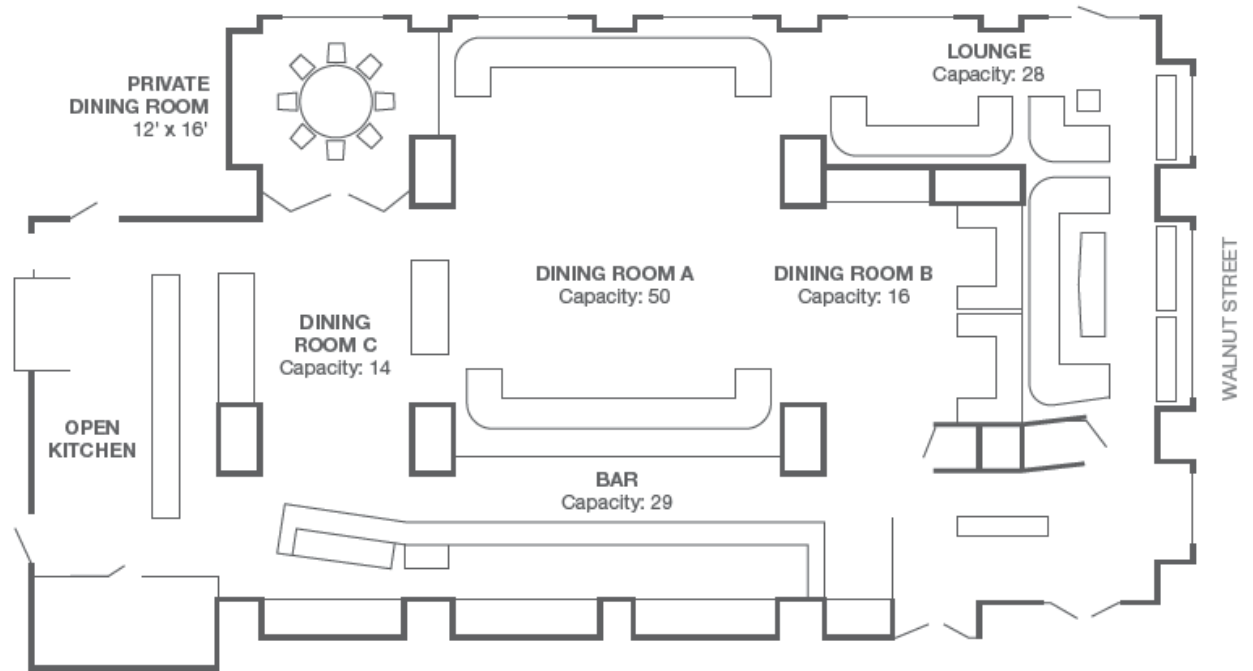



## COCKTAIL TERRACE

With unparalleled views of downtown Cincinnati our Cocktail Terrace takes events to the next level. From sophisticated soirees to posh private pampering sessions, your event is guaranteed to rise above the rest.

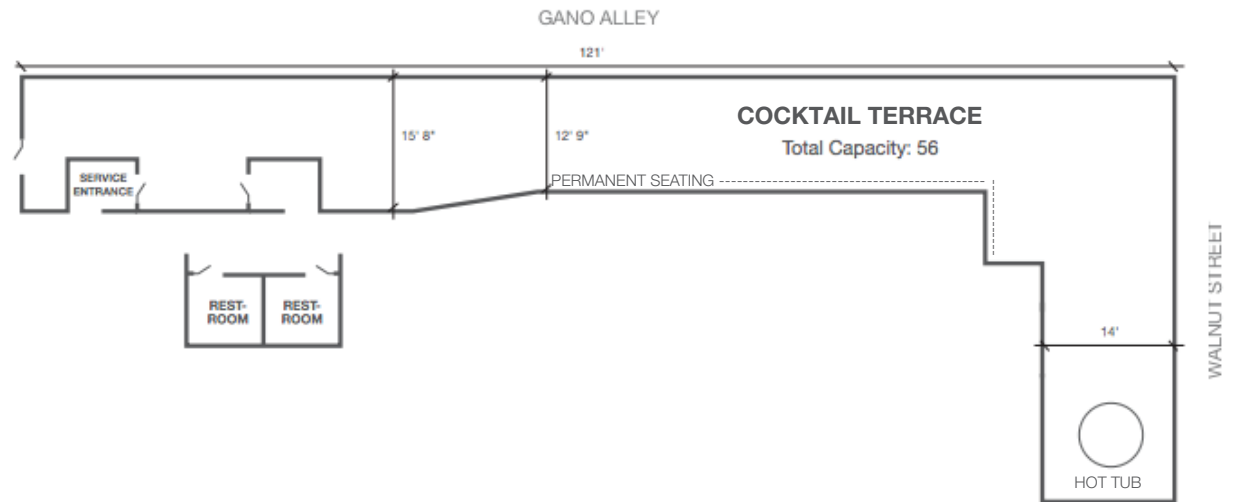



# GATHER AT 21c MUSEUM HOTEL AND METROPOLE

21c has over 8,000 square feet of art-filled event space in the heart of downtown arts and entertainment district. Featuring a wide range of spaces – many with cutting edge audiovisual technology and large light-filled windows – 21c is the perfect venue for board retreats, executive meetings, cocktail gatherings, reception dinners, charitable events, intimate weddings or any other special occasion.

Room	Dimensions	Square Footage	Banquet (rounds)	Banquet (rounds w/ dance floor)	Banquet (rounds w/ podium or a/v)	Banquet (rounds w/ buffet or bar in room)	Reception	Hollow Square	Theatre	U-Shape	Conf.	Classrm	Crescent	Tradeshow (# of 6' tables - perimeter)
<b>Main Gallery</b>	38' x 50'	1900	120	80	96	80	200	40	140	40	40	72	65	14
<b>Gallery One</b>	29' x 41'	1189	64	n/a	50	45	75	n/a	75	n/a	n/a	n/a	n/a	10
<b>Gallery Two</b>	41' x 21'	861	56	40	48	48	70	30	65	22	28	30	36	12
<b>Gallery Three</b>	26' x 22'	570	n/a	n/a	n/a	n/a	50	n/a	n/a	n/a	n/a	n/a	n/a	8
<b>Gallery Four</b>	15' x 29'	435	32	n/a	24	24	35	12	30	15	15	15	15	6
<b>Gallery Five</b>	13' x 12'	156	12	n/a	n/a	n/a	n/a	n/a	n/a	n/a	n/a	n/a	n/a	n/a
<b>Conference Room</b>	30' x 13'	390	n/a	n/a	n/a	n/a	n/a	n/a	n/a	n/a	12	n/a	n/a	n/a
<b>Cocktail Terrace</b>	—	1863	n/a	n/a	n/a	n/a	56	n/a	n/a	n/a	n/a	n/a	n/a	n/a